



www.soilandforestryservices.com

Project Number: 22-0048

Date: 4/18/22

Joseph Pinchbeck

Attn: *Joseph Pinchbeck*

Email: sephpinchbeck@gmail.com

**Re: On-Site Wastewater Evaluation for a 3 Bedroom Residence on 4960 CHUCKS LN,
Parcel: 369603436262, Denver, NC 28037.**

Joseph,

Soil & Forestry Services of the Carolinas, PA has performed a Preliminary Soil Evaluation on the above mentioned property in Catawba County, NC. The purpose of the evaluation was to determine soil suitability for a 3 bedroom onsite wastewater system. The evaluation was performed on April 4th, 2022.

The findings from our evaluation are illustrated on the attached Soil Map. Soil boring locations, and usable soil boundary were located via GPS. This data was imported into the Catawba County GIS Parcel Data for the property and utilized to produce the Soil Map.

Soil/Site Suitability

Five soil borings (B1 – B5) were performed to determine the overall soil suitability for an onsite wastewater system installation. Of these five borings all were found to be provisionally suitable for Conventional, Modified Conventional and/or Accepted subsurface wastewater systems. These soil profile descriptions are most similar to the Cecil Soil Series'. Recommended LTAR is 0.25-0.3gpd/ft². The square footage requirement for a 3 bedroom Conventional, Modified Conventional or Accepted System (system and repair) is 8,000 – 13,000. **We have determined that there is ~24,000 SF of usable soil to support a drainfield for a 3 BR residence. This is pending house placement, driveway and well are sited to preserve sufficient available space of usable soil. I would recommend staking a proposed new house location on the lot and performing an on-ground layout of system and repair to determine if it is feasible.** We also recommend getting permits for neighboring lots to determine where a well can be placed.

Soil & Forestry Services of the Carolinas, PA has appreciates your business and looks forward to working with you in the future. Please let us know if you need any further assistance or have questions in regards to this project.

Thank you

S. Ashley Rollans

NC Licensed Soil Scientist #1231

See Attached: Soil Map

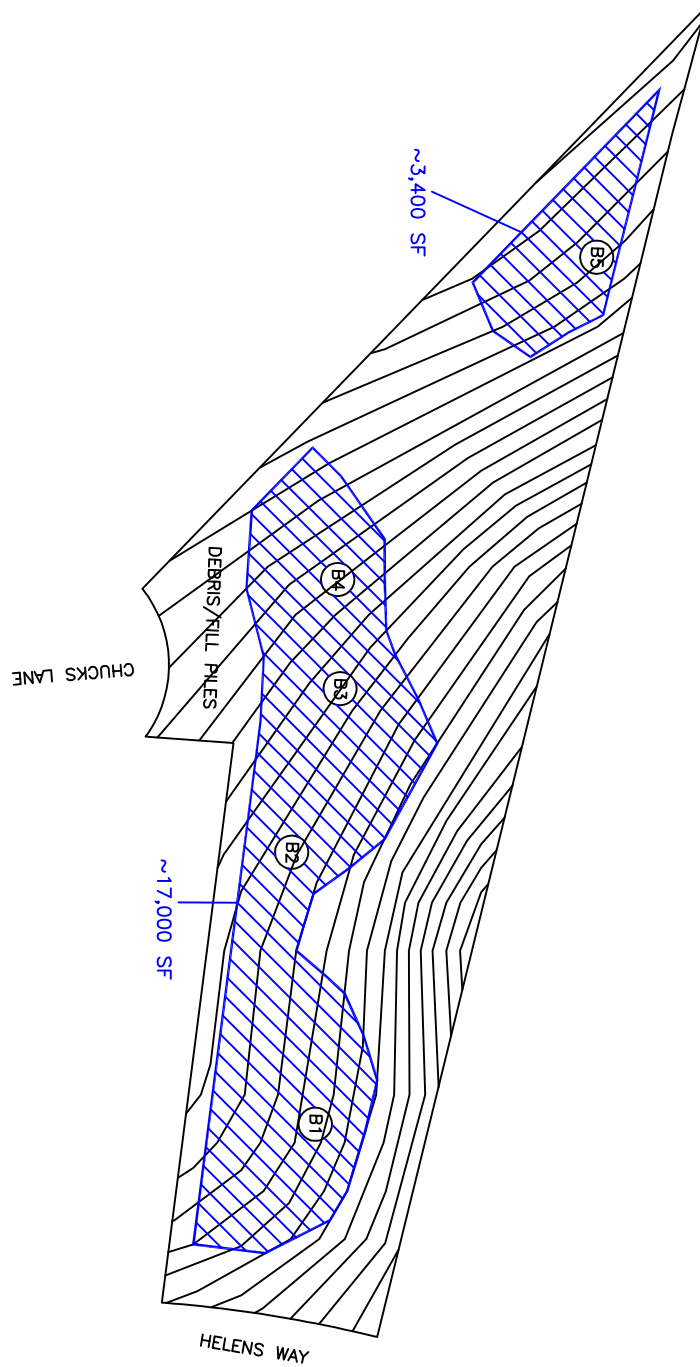

LEGEND

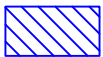

Areas contain at least 36 inches of usable material and have potential for accepted, modified conventional and conventional septic systems.

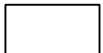

Unsuitable.



Boring Locations.

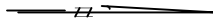

GRAPHIC SCALE
1" = 80'



FOR PRELIMINARY PLANNING PURPOSES ONLY. ALL LOTS WILL REQUIRE FINAL APPROVAL BY THE COUNTY HEALTH DEPARTMENT ON A LOT BY LOT BASIS. THIS MAP SHOULD BY USED AS A GENERAL GUIDE, SOME ADJUSTMENTS WILL BE NECESSARY IN THE FIELD DUE TO SOIL VARIABILITY AND COMPLEX TOPOGRAPHIC FEATURES. THIS MAP ONLY REFLECTS EXISTING SOIL SUITABILITY FOR ON-SITE SEPTIC TANK SYSTEMS.

SOIL & FORESTRY SERVICES OF THE CAROLINAS, PA.

P.O. BOX 832
MOORESVILLE, NC 28115
PHONE: (704) 746 - 5046

ASHLEY ROLLANS, NC LICENSED SOIL SCIENTIST
MOBILE: (704) 746 - 5046
EMAIL: ASHLEYROLLANS@GMAIL.COM

MAP TITLE:

PRELIMINARY SOIL EVALUATION

PROJECT NAME:

JOSEPH PINCHBECK / 4060 CHUCKS LANE

LOCATION/DATE:

4060 CHUCKS LANE
CATAWBA COUNTY, NORTH CAROLINA
APRIL 2022

JOB # :

22-0048

FILE:

C:\JOBS\22-0048

PROJECT MGR.:

S.A.R.

FIELD WORK:

S.A.R.

DRAWN BY:

S.A.R.