

# **ROLLANS Soil & Environmental Services, P.A.**

101 Blywood, Mooresville, NC 28137 Phone: 704-746-5046 Fax: 704-746-5046

Ashley Rollans, NC Licensed Soil Scientist, Certified Septic Installer, Certified Wastewater Operator & Certified Septic Inspector. Contacts: 704-746-5046

Email: [rollans@ashleyrollans.com](mailto:rollans@ashleyrollans.com)

Project Number: 01-1811

Date: 4/15/13

Mike Pinney  
509 Stater Street  
Greenville, OH 45331-1258

**Re: On-Site Wastewater Evaluation on Lots 19 & 20 in Seven Oaks Subdivision,  
Vance Farm Road, Iredell County, NC.**

Dear Mr. Penney,

Rollans Soil & Environmental Services, PA has performed a Preliminary Soil Evaluation on the above mentioned property in Iredell County, NC. The purpose of the evaluation was to determine available space requirement for System and Repair to allow for the construction of a 3-4 bedroom residence on each lot. The evaluation was performed in March 25<sup>th</sup>, 2013.

The findings from our evaluation are illustrated on the attached Site Plan. Additional documentation of the soil evaluation is detailed in the NCDENR for Soil Profile Descriptions.

## **Lot 19**

Three soil borings (B1 - B3) were performed on the front portion of this lot and found to be suitable for Conventional and Accepted subsurface wastewater systems. These soil profile descriptions are most similar to the Cecil Soil Series. There is an ephemeral drainage toward the back of this lot that is surrounded by steep slopes and unsuitable topography. This lot has sufficient available space to support a 4 bedroom residence if the home is placed beyond the usable soil area in the front. This will require the use of a pump system.

## **Lot 20**

Five soil borings (B4 - B8) were performed on the front and rear portions of this lot and found to be suitable for Conventional and Accepted subsurface wastewater systems with the exception of B5. The soil profile descriptions are most similar to the Cecil Soil Series. The Unsuitable soil profile (B5) is most similar to the Wilkes Soil Series. There is an ephemeral drainage creek toward the middle of this lot that is surrounded by steep slopes. This lot has sufficient available space to support a 3-4 bedroom residence if the

home is placed along the front building setback will primary system behind the house and repair on the back side of the lot across the drainageway.

Rollans Soil & Environmental Services, PA has appreciates your business and looks forward to working with you in the future. Please let us know if you need any further assistance or have questions in regards to this project.

Thank you  
S. Ashley Rollans  
*NC Licensed Soil Scientist #1231*  
*NC Certified Operator*  
*NC Certified Septic Installer*  
*NC Certified Septic Inspector*



See Attached: *Site Plan*  
*Soil Profile Descriptions*

01-19-11

**CONNECTGIS** **IREDELL COUNTY**

The maps prepared for this website are generated from recorded deeds, plats and other public records. Users of these maps are hereby notified that the information provided herein should be verified. Iredell County assumes no legal responsibility for any of the information contained on this site. Users are advised that the use of any of this information is at their own risk. All maps on the site were prepared using a 2000a1™ Grid based upon the North Carolina State Plane Coordinate System from the 1983 North American Datum. The delinquent real property tax overlay is updated monthly. The information presented is not intended to be used or relied upon as official notice of tax liens. For additional information regarding delinquent taxes, contact the Iredell County Tax Collector's Office.

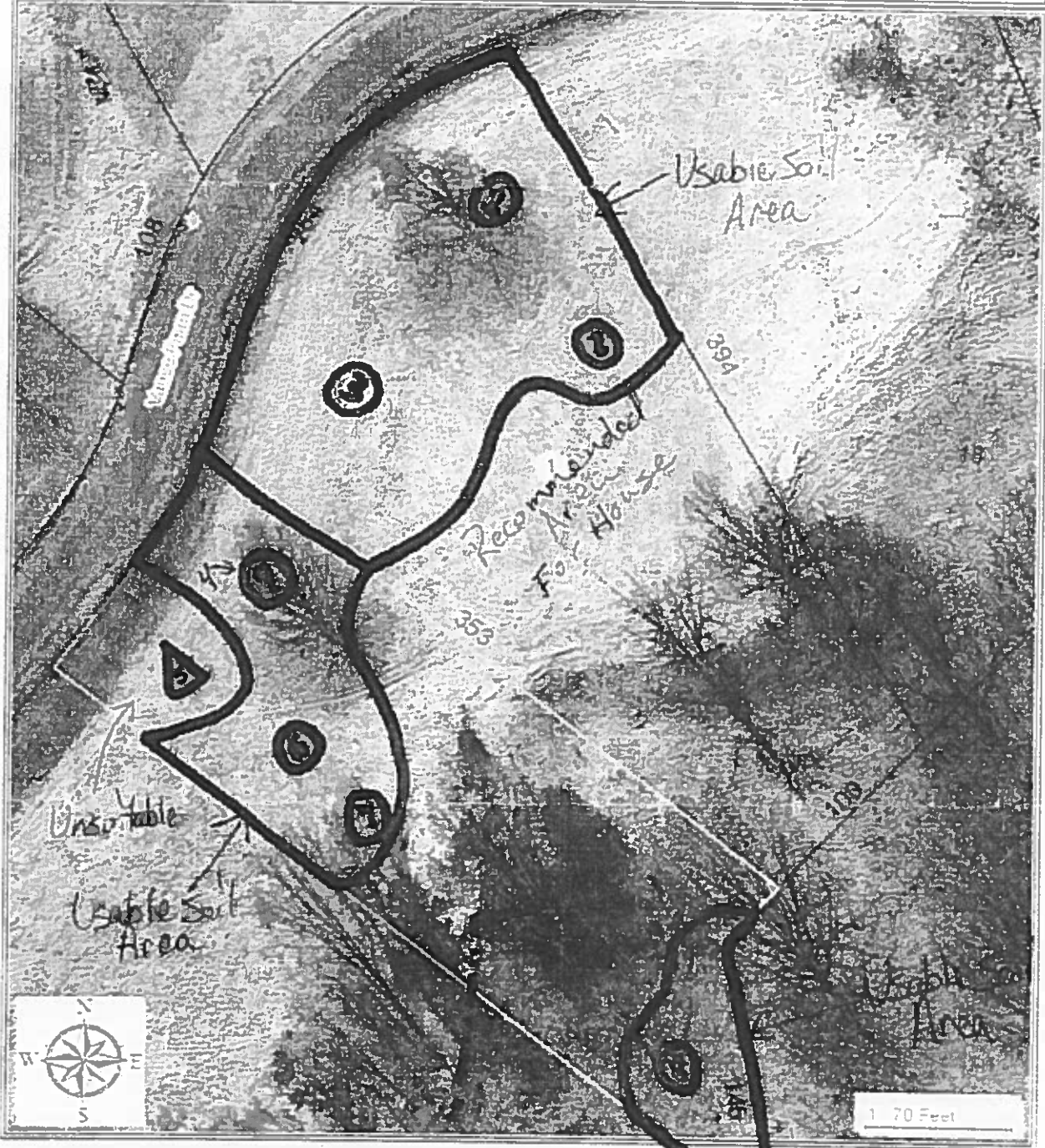

**SOIL/SITE EVALUATION**  
**for ON-SITE WASTEWATER SYSTEM**

OWNER: M. Ko Ferrer  
 ADDRESS: Lot 7.00 Calle 5a - 110  
 PROPOSED FACILITY: 113' PROPOSED DESIGN FLOW (1949): 480  
 LOCATION OF SITE: \_\_\_\_\_ APPLICATION DATE: \_\_\_\_\_  
 DATE EVALUATED: 3/25/13  
 PROPERTY SIZE: 2.5 ac  
 PROPERTY RECORDED: \_\_\_\_\_  
 WATER SUPPLY:  Private  Public  Well  Spring  Other \_\_\_\_\_  
 EVALUATION METHOD:  Auger Boring  Pit  Cut TYPE OF WASTEWATER:  Sewage  Industrial Process  Mixed

| P<br>R<br>O<br>F<br>I<br>L<br>E<br><br># | .1940<br>LANDSCAPE<br>POSITION/<br>SLOPE % | HORIZON<br>DEPTH<br>(IN.) | SOIL MORPHOLOGY<br>(.1941)     |                                     | OTHER<br>PROFILE FACTORS           |                        |                         |                         | PROFILE<br>CLASS<br>& LTAR |
|--|--|---------------------------|--------------------------------|-------------------------------------|------------------------------------|------------------------|-------------------------|-------------------------|----------------------------|
|  |  |                           | .1941<br>STRUCTURE/<br>TEXTURE | .1941<br>CONSISTENCE/<br>MINERALOGY | .1942<br>SOIL<br>WETNESS/<br>COLOR | .1943<br>SOIL<br>DEPTH | .1956<br>SAPRO<br>CLASS | .1944<br>RESTR<br>HORIZ |                            |
|  |  |                           |                                |                                     |                                    |                        |                         |                         |                            |
| 1  | 4/13%                                      | 0-6                       | Bclw/sbk                       | FSSSPSE4                            | F2C<br>F2F                         | 48                     | -                       | -                       | PS<br>0.3                  |
|  |  | 6-42                      | Rclw/sbk                       | " " " "                             |                                    |                        |                         |                         |                            |
|  |  | 42-48                     | Rclw/sbk                       | " " " "                             |                                    |                        |                         |                         |                            |
|  |  |                           |                                |                                     |                                    |                        |                         |                         |                            |
| 2  | 4/16%                                      | 0-6                       | B1sr                           | FSSSPSE4                            | F2C<br>F2F                         | 48                     | -                       | -                       | PS<br>0.3                  |
|  |  | 6-11                      | Rclw/sbk                       | " " " "                             |                                    |                        |                         |                         |                            |
|  |  | 11-48                     | Rcunslot/alk                   | " " " "                             |                                    |                        |                         |                         |                            |
|  |  |                           |                                |                                     |                                    |                        |                         |                         |                            |
| 3  | 4/17%                                      | 0-4                       | B1sr                           | FSSSPSE4                            | F2C<br>F2F                         | 48                     | -                       | -                       | PS<br>0.3                  |
|  |  | 4-12                      | Rclw/sbk                       | " " " "                             |                                    |                        |                         |                         |                            |
|  |  | 12-48                     | Rcunslot/alk                   | " " " "                             |                                    |                        |                         |                         |                            |
|  |  |                           |                                |                                     |                                    |                        |                         |                         |                            |
| 4  | 4/8%                                       | 0-4                       | B1sr                           | FSSSPSE4                            | F2C<br>F2F                         | 48                     | -                       | -                       | PS<br>0.3                  |
|  |  | 4-11                      | Rclw/sbk                       | " " " "                             |                                    |                        |                         |                         |                            |
|  |  | 11-30                     | Rcunslot/sid                   | FSSSPSE4                            |                                    |                        |                         |                         |                            |
|  |  | 30-43                     | Rclw/sbk                       | FSSSPSE4                            |                                    |                        |                         |                         |                            |
|  |  | 43-48                     | Rclw/sbk                       | " " " "                             |                                    |                        |                         |                         |                            |

| DESCRIPTION             | INITIAL SYSTEM | REPAIR SYSTEM | OTHER FACTORS (.1946):                 |
|-------------------------|----------------|---------------|--|
| Available Space (.1945) | PS             | PS            | SITE CLASSIFICATION (.1948): <u>PS</u> |
| System Type(s)          | PPBPS          | PPBPS         | EVALUATED BY: <u>S. Ashley Rollins</u> |
| Site LTAR               | 0.3            | 0.3           | OTHER(S) PRESENT: _____                |
| COMMENTS:               | _____          |               |  |

# SOIL/SITE EVALUATION

(Continuation Sheet)

Sheet      of     

DEPARTMENT OF ENVIRONMENT  
AND NATURAL RESOURCES  
DIVISION OF ENVIRONMENTAL HEALTH

PROPERTY ID # \_\_\_\_\_  
DATE OF EVALUATION: \_\_\_\_\_  
COUNTY: Inyo

*Mike Pannoy*

| P<br>R<br>O<br>F<br>I<br>L<br>E<br># | .1940<br>LANDSCAPE<br>POSITION/<br>SLOPE % | HORIZ<br>ON<br>DEPTH<br>(IN.) | SOIL MORPHOLOGY<br>(.1941)     |                                     | OTHER<br>PROFILE FACTORS           |                        |                         |                         | PROFILE<br>CLASS<br>& LTAR |  |
|--------------------------------------|--|-------------------------------|--------------------------------|-------------------------------------|------------------------------------|------------------------|-------------------------|-------------------------|----------------------------|--|
|                                      |  |                               | .1941<br>STRUCTURE/<br>TEXTURE | .1941<br>CONSISTENCE/<br>MINERALOGY | .1942<br>SOIL<br>WETNESS/<br>COLOR | .1943<br>SOIL<br>DEPTH | .1956<br>SAPRO<br>CLASS | .1944<br>RESTR<br>HORIZ |                            |  |
| B<br>5                               | L/7%                                       | 0-3                           | B-5r                           | Fissile                             | W                                  |                        |                         |                         | 2                          |  |
|                                      |  | 3-13                          | Bt-4sbt                        |                                     | W                                  |                        |                         |                         |                            |  |
|                                      |  | 13-18                         | R-4ms-4/40r                    |                                     | W                                  |                        |                         |                         |                            |  |
|                                      |  | 18"                           | RR                             |                                     |                                    |                        |                         |                         |                            |  |
| B<br>6                               | L/5%                                       | 0-5                           | B1-5r                          | Fissile                             |                                    |                        |                         |                         | 2                          |  |
|                                      |  | 5-9                           | BKcl-4sbt                      |                                     |                                    |                        |                         |                         |                            |  |
|                                      |  | 9-48                          | RBC-4msb                       | F3B-4sbt                            |                                    | 40                     |                         |                         |                            |  |
|                                      |  |                               |                                |                                     |                                    |                        |                         |                         |                            |  |
| B<br>7                               | L/20%                                      | 0-11                          | Bc-4msb                        | Fissile                             |                                    |                        |                         |                         | 2                          |  |
|                                      |  | 11-48                         | RBC-4msb                       | Fissile                             | Part<br>fines                      | 30                     |                         |                         |                            |  |
|                                      |  |                               |                                |                                     |                                    |                        |                         |                         |                            |  |
|                                      |  |                               |                                |                                     |                                    |                        |                         |                         |                            |  |
| B<br>8                               | L/15%                                      | 0-3                           | B1-5r                          | Fissile                             |                                    |                        |                         |                         | 2                          |  |
|                                      |  | 3-7                           | BKcl-4sbt                      |                                     |                                    |                        |                         |                         |                            |  |
|                                      |  | 7-20                          | Rc-4msbt                       |                                     | 40                                 | 15                     |                         |                         |                            |  |
|                                      |  | 20-24                         | RKcl-4sbt                      |                                     |                                    |                        |                         |                         |                            |  |
|                                      |  | 24-48                         | var. masses                    |                                     |                                    |                        |                         |                         |                            |  |
|                                      |  |                               |                                |                                     |                                    |                        |                         |                         |                            |  |
|                                      |  |                               |                                |                                     |                                    |                        |                         |                         |                            |  |
|                                      |  |                               |                                |                                     |                                    |                        |                         |                         |                            |  |
|                                      |  |                               |                                |                                     |                                    |                        |                         |                         |                            |  |
|                                      |  |                               |                                |                                     |                                    |                        |                         |                         |                            |  |

COMMENTS: \_\_\_\_\_  
 \_\_\_\_\_  
 \_\_\_\_\_